





-  Punto de luz.
-  Llave para acceso peatonal independiente del bloque.
-  Acceso de vehículo para carga y descarga con llave magnética.
-  Ascensor para seis personas.

# TRASTEROS EN ALQUILER Y VENTA

GESTIONA:



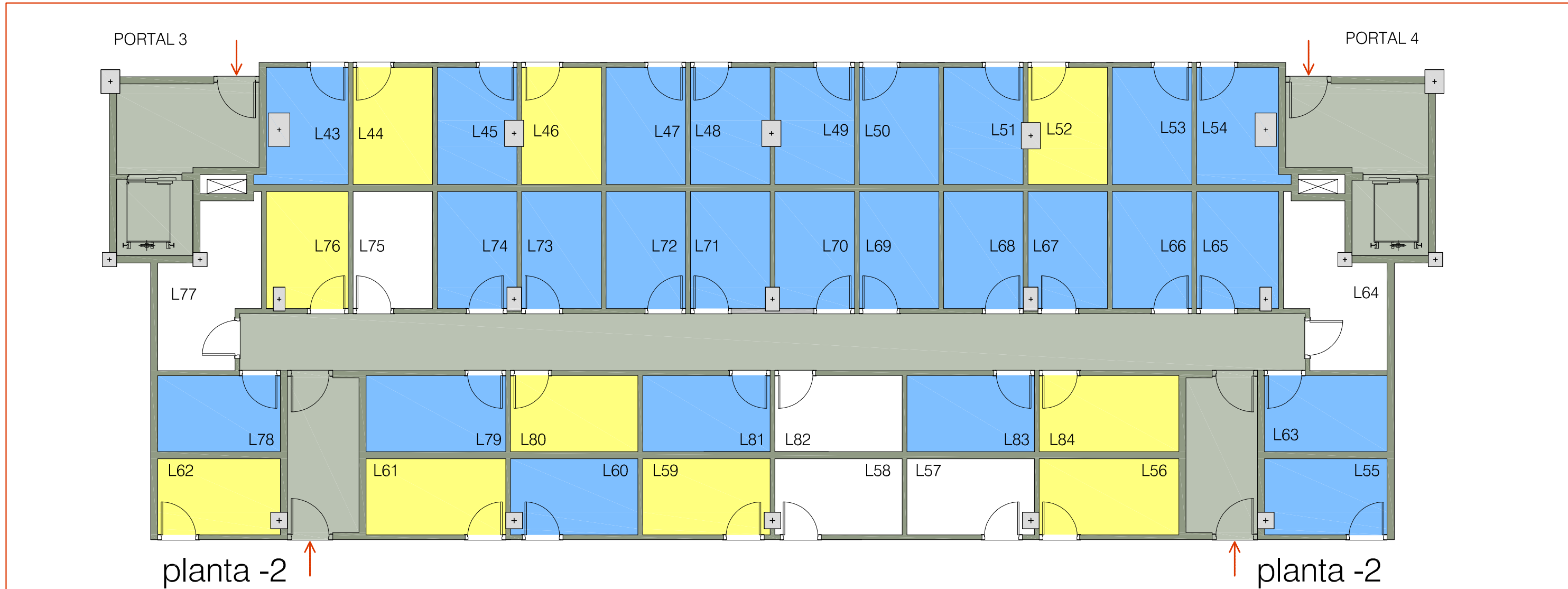

## DISPONIBILIDAD DE TRASTEROS PLANTA -2

Edificio Avd. Juan Pablo II, frente a Feria de Sevilla.



### DISPONIBILIDAD DE TRASTEROS

-  Trastero libre
-  Trastero alquilado
-  Trastero vendido

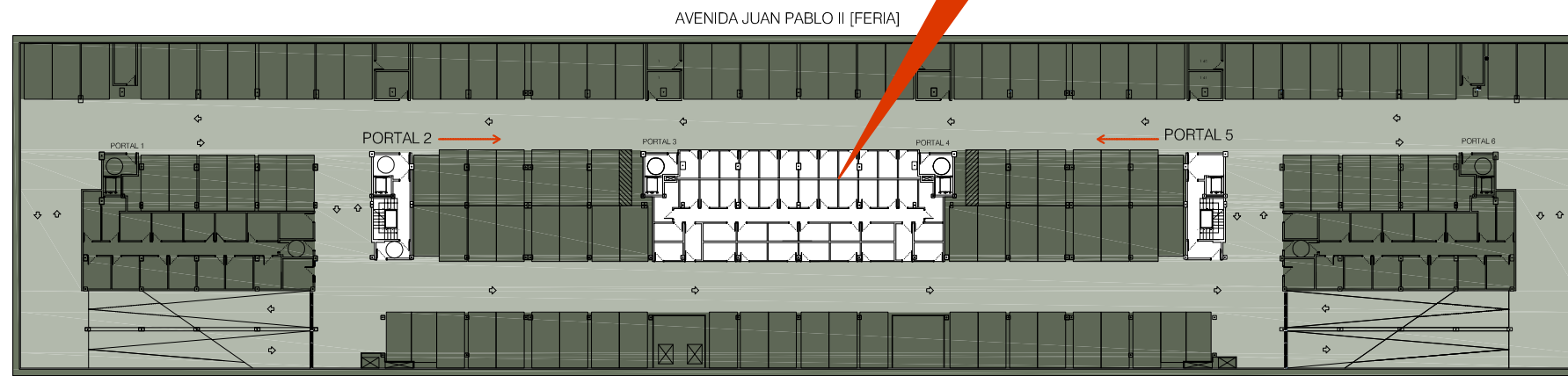

Planta -2